



## PFT - the Flexible Pressure Transmitter

The PFT is distinguished by its high-quality measurement technology. The device is well suited to solve demanding measurement tasks in industrial applications.

The pressure transmitter PFT is designed for pressure measurement in liquid and gaseous media. The PFT targets industrial applications such as in machine and plant engineering, in machine tool systems, in hydraulic and pneumatic systems, for pressure control systems and for pumps and compressors.

Starting from a smallest measurement range of 0...0.1 bar, there is a large number of measurement ranges available up to 600 bar. In addition, the PFT offers absolute and compound ranges. The PFT has a very good measurement accuracy across the entire operating temperature range. Its accuracy is  $\pm 0.5\%$  of the span ( $\pm 0.25\%$  of span optionally available). A version with an extended temperature range up to 150 °C is available.

The PFT has a circularly welded stainless steel membrane. Hence, there are no internal sealing elements and it is well suited for a large variety even of corrosive media. As there is a large multitude of customary process connectors available as standard, no additional adapters are needed. The PFT is wear-free and does not require maintenance. The pressure in specific media such as sludges, slurries, pulp or highly viscous liquids can be measured through an optionally available flush-mounted stainless steel membrane.

The PFT offers the industry standard output signals 4...20mA, 0...10V, or 0...5V. The transmitter's span and zero point can be adjusted. For electrical connection, M12x1 connectors, L-connectors according to DIN 175301-803 A, and cable outlets are available.

### Benefits

- Wide application range
- High accuracy across wide temperature range
- Large number of configurations possible to meet customer requirements
- Trouble-free as no moving parts: No mechanical wear, fatigue-proof, maintenance-free
- Insensitive against corrosive media through hermetically sealed stainless steel membrane
- Quick and simple installation



## Technical Data

Configurations	Unit	Pressure ranges	Overpressure safety	Burst pressure	Pressure ranges	Overpressure safety	Burst pressure
	bar	0...0.1	2	5	0...10	35	42
	bar	0...0.16	1.5	2	0...16	80	96
	bar	0...0.25	2	2.4	0...25	50	96
	bar	0...0.4	2	2.4	0...40	80	400
	bar	0...0.6	4	4.8	0...60	120	550
	bar	0...1	5	6	0...100	200	800
	bar	0...1.6	10	12	0...160	320	1000
	bar	0...2.5	10	12	0...250	500	1200
	bar	0...4	17	20.5	0...400	800	1700**)
	bar	0...6	35	42	0...600	1200	2400**)
	bar abs	0...0.25	2	2.4	0...4	17	20.5
	bar abs	0...0.4	2	2.4	0...6	35	42
	bar abs	0...0.6	4	4.8	0...10	35	42
	bar abs	0...1	5	6	0...16	80	96
	bar abs	0...1.6	10	12	0...25 <sup>*)</sup>	80	96
	bar abs	0...2.5	10	12			
	bar	-1...0	5	6	-1...+9	35	42
	bar	-1...+0.6	10	12	-1...+15	80	96
	bar	-1...+1.5	10	12	-1...+24	50	96
	bar	-1...+3	17	20.5	-1...+30 <sup>*)</sup>	80	400
	bar	-1...+5	35	42			
Unit	Pressure ranges	Overpressure safety	Burst pressure	Pressure ranges	Overpressure safety	Burst pressure	
MPa	0...0.01	0.1	0.2	0...1	3.5	4.2	
MPa	0...0.016	0.15	0.2	0...1.6	8	9.6	
MPa	0...0.025	0.2	0.24	0...2.5	5	9.6	
MPa	0...0.04	0.2	0.24	0...4	8	40	
MPa	0...0.06	0.4	0.48	0...6	12	55	
MPa	0...0.1	0.5	0.6	0...10	20	80	
MPa	0...0.16	1	1.2	0...16	32	100	
MPa	0...0.25	1	1.2	0...25	50	120	
MPa	0...0.4	1.7	2.0	0...40	80	170**)	
MPa	0...0.6	3.5	4.2	0...60	120	240**)	
MPa abs	0...0.025	0.2	0.24	0...0.4	1.7	2.05	
MPa abs	0...0.04	0.2	0.24	0...0.6	3.5	4.2	
MPa abs	0...0.06	0.4	0.48	0...1.0	3.5	4.2	
MPa abs	0...0.1	0.5	0.6	0...1.6	8	9.6	
MPa abs	0...0.16	1	1.2	0...2.5 <sup>*)</sup>	8	9.6	
MPa abs	0...0.25	1	1.2				
MPa	-0.1...0	0.5	0.6	-0.1...+0.9	3.5	4.2	
MPa	-0.1...+0.15	1	1.2	-0.1...+1.5	8	9.6	
MPa	-0.1...+0.3	1.7	2.0	-0.1...+2.4	5	9.6	
MPa	-0.1...+0.5	3.5	4.2				

\*) not available with flush-mounted membrane

\*\*\*) with flush-mounted membrane: the value specified in the table applies only when sealing is realised with the sealing ring underneath the hex. Otherwise max. 1500 bar applies

## Technical Data

Configurations	Unit	Pressure ranges	Overpressure safety	Burst pressure	Pressure ranges	Overpressure safety	Burst pressure
	psi	0...5	29	34.8	0...300	1160	1390
	psi	0...10	29	34.8	0...500	1160	5800
	psi	0...15	72.5	87	0...1000	1740	7980
	psi	0...25	145	170	0...1500	2900	11600
	psi	0...30	145	170	0...2000	4600	14500
	psi	0...50	240	290	0...3000	7200	17400
	psi	0...100	500	600	0...5000	11600	24650**)
	psi	0...160	500	600	0...8000	17400	34800**)
	psi	0...200	1160	1390			
	psi abs	0...15	72.5	87	0...100	500	600
	psi abs	0...25	145	170	0...250	1160	1390
	psi abs	0...50	240	290			
	psi	-30 InHg...0	72.5	87	-30 InHg...+160	1160	1390
	psi	-30 InHg...+30	240	290	-30 InHg...+200	1160	1390
	psi	-30 InHg...+60	240	290	-30 InHg...+300	1160	1390
	psi	-30 InHg...+100	500	600			
Unit	Pressure ranges	Overpressure safety	Burst pressure	Pressure ranges	Overpressure safety	Burst pressure	
	kg/cm <sup>2</sup>	0...0.1	1	2	0...10	35	42
	kg/cm <sup>2</sup>	0...0.16	1,5	2	0...16	80	96
	kg/cm <sup>2</sup>	0...0.25	2	2.4	0...25	50	96
	kg/cm <sup>2</sup>	0...0.4	2	2.4	0...40	80	400
	kg/cm <sup>2</sup>	0...0.6	4	4.8	0...60	120	550
	kg/cm <sup>2</sup>	0...1	5	6	0...100	200	800
	kg/cm <sup>2</sup>	0...1.6	10	12	0...160	320	1000
	kg/cm <sup>2</sup>	0...2.5	10	12	0...250	500	1200
	kg/cm <sup>2</sup>	0...4	17	20.5	0...400	800	1700**)
	kg/cm <sup>2</sup>	0...6	35	42	0...600	1200	2400**)
	kg/cm <sup>2</sup> abs	0...0.25	2	2.4	0...4	17	20.5
	kg/cm <sup>2</sup> abs	0...0.4	2	2.4	0...6	35	42
	kg/cm <sup>2</sup> abs	0...0.6	4	4.8	0...10	35	42
	kg/cm <sup>2</sup> abs	0...1	5	6	0...16	80	96
	kg/cm <sup>2</sup> abs	0...1.6	10	12	0...25*)	80	96
	kg/cm <sup>2</sup> abs	0...2.5	10	12			
	kg/cm <sup>2</sup>	-1...0	5	6	-1...+5	35	42
	kg/cm <sup>2</sup>	-1...+0.6	10	12	-1...+9	35	42
	kg/cm <sup>2</sup>	-1...+1.5	10	12	-1...+15	80	96
	kg/cm <sup>2</sup>	-1...+3	17	20.5	-1...+24	50	96
Unit	Pressure ranges	Overpressure safety	Burst pressure	Pressure ranges	Overpressure safety	Burst pressure	
	bar abs	800...1200	10000	12000			
	mbar	-600...0	4000	4800	-160...0	1500	2000
	mbar	-400...0	2000	2400	-100...0	1000	2000
	mbar	-250...0	2000	2400			

\*) not available with flush-mounted membrane

\*\*) with flush-mounted membrane: the value specified in the table applies only when sealing is realised with the sealing ring underneath the hex. Otherwise max. 1500 bar applies

## Technical Data

### Materials

#### ■ Wetted parts

Standard

Stainless steel

With flush-mounted diaphragm

Stainless steel

O-ring: NBR <sup>1)</sup> FPM/FKM optional

#### ■ Internal transmission fluid <sup>2)</sup>

Synthetic oil

<sup>1)</sup> O-ring made of FPM/FKM for version with flush-mounted membrane with integrated cooling element

<sup>2)</sup> Not available for version with standard membrane for pressure ranges > 25 bar

#### ■ Housing

Stainless steel

Power supply L<sup>+</sup>

10 ... 30 V DC

(14 ... 30 V DC with signal output 0 ... 10 V)

Signal output and maximum ohmic load R<sub>A</sub>

4 ... 20 mA, 2-wire

R<sub>A</sub> ≤ (L<sup>+</sup> - 10 V) / 0.02 A [Ohm]

0 ... 5 V, 3-wire

R<sub>A</sub> > 5 k Ohm

0 ... 10 V, 3-wire

R<sub>A</sub> > 10 k Ohm

other signal outputs on request

Adjustability zero/span

± 5% using potentiometers inside the instrument

Response time (10 ... 90 %)

≤ 1ms (≤ 10 ms at medium temperatures below < -30 °C for pressure ranges up to 25 bar or with flush-mounted membrane)

Dielectric strength

500 VDC <sup>3)</sup>

<sup>3)</sup> NEC Class 02 power supply (low voltage and low current max. 100 VA even under fault conditions)

Accuracy

≤ 0.5 % of span <sup>4)</sup>

≤ 0.25 % of span <sup>4)</sup> optionally available for pressure ranges ≥ 0.25 bar

<sup>4)</sup> Including non-linearity, hysteresis, zero point and full scale error (corresponds to error of measurement per IEC 61298-2)

Non-linearity

≤ ± 0.2 % of span

(BFSL) according to IEC 61298-2

Non-repeatability

≤ ± 0.1 % of span

1-year stability

≤ ± 0.2 % of span

(at reference conditions)

Permissible temperature of

PFT standard version

additionally with flush-mounted membrane and cooling element

#### ■ Medium

-30 ... +100 °C

-40 ... +125 °C optional

-20 ... +150 °C

#### ■ Ambience

-20 ... +80 °C

-20 ... +80 °C

#### ■ Storage

-40 ... +100 °C

-20 ... +100 °C

Compensated temp. range

0 ... +80 °C

Temperature coefficients within compensated temp range

#### ■ Mean TC of zero

≤ 0.2 / 10 K % of span (< 0.4 for pressure range ≤ 0.25 bar)

#### ■ Mean TC of span

≤ 0.2 / 10 K % of span

CE-conformity

#### ■ Pressure equipment directive

97/23/EC

#### ■ EMC directive

2004/108/EC

EN 61 326-2-3

Enclosure rating <sup>5)</sup>

IP 67

IP 68 for configuration with specific integrated cable output (zero and span not adjustable)

IP 65 for configuration with L-connector

<sup>5)</sup> Ingress protection IP per IEC 60529. The ingress protection classes specified only apply while the pressure transmitter is connected with female connectors that provide the corresponding ingress protection.

Shock resistance

1000g according to IEC 60068-2-27

(mechanical shock)

Vibration resistance

20g according to IEC 60068-2-6

(vibration under resonance)

Wiring protection

#### ■ Protection class

III

#### ■ Overvoltage protection

36 VDC

#### ■ Short-circuit proofness

Q<sub>A</sub> towards M

#### ■ Reverse polarity protection

L<sup>+</sup> towards M

Weight

Approx. 200g

Approx. 300g with option accuracy 0.25% of span (due to longer housing)

**Dimensions in mm**

M 12 x 1 Circular connector  
 Order code: M  
 Housing at 0.5 % accuracy  
 Order code: S  
 Process connection G 1/2 acc. to EN 837  
 Order code: GD

DIN 175301-803 A L-connector  
 Order code: L  
 Housing at 0.5 % accuracy  
 Order code: S  
 Process connection G1/2 acc. to EN 837  
 Order code: GD

DIN 175301-803 A L-connector  
 Order code: L  
 Housing at 0.25 % accuracy  
 Order code: A  
 Process connection G1/2 acc. to EN 837  
 Order code: GD

Flying leads  
 Order code: 1.5m cable: 1  
 3.0m cable: 3  
 Housing at 0.5 % accuracy  
 Order code: S  
 Process connection G1/2 acc. to EN 837  
 Order code: GD

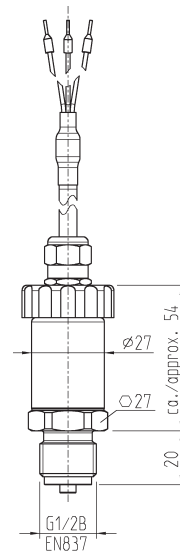
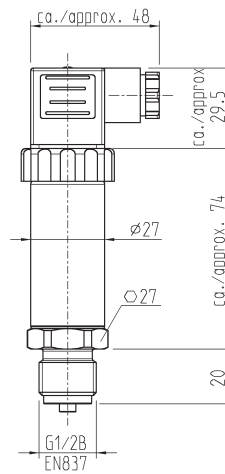
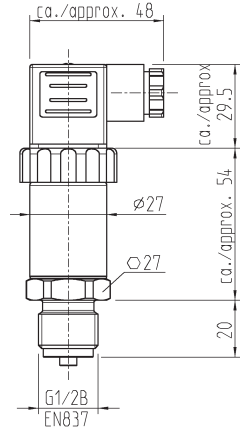
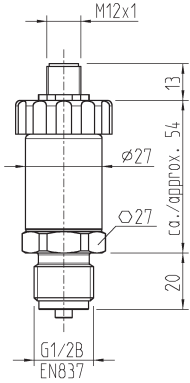

**Process connections**

G 1/2 B EN 837  
 Order code: GD

G 1/4 DIN 3852-E  
 (over pressure safety max. 600 bar)  
 Order code: G1

G 1/4 female  
 Order code: G2

1/4" NPT  
 Order code: N1

R 1/4 ISO 7  
 Order code: R1

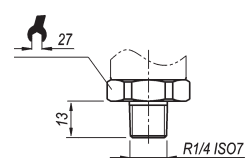
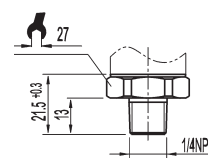
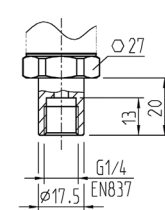
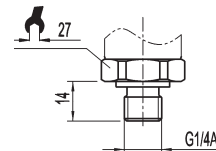
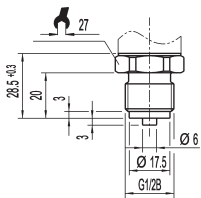

**Process connections, flush-mounted membrane**

M 20 x 1,5  
 with sealing copper or stainless steel  
 Order code: M2

7/16" -20 UNF  
 Order code: U1

G 1 B with or without cooling element  
 0 ... 0.1 up to 0 ... 1.6 bar  
 Order code: F1

G 1 B with or without cooling element  
 0 ... 2.5 up to 0 ... 600 bar  
 Max. overpressure safety 600 bar  
 Order code: F2

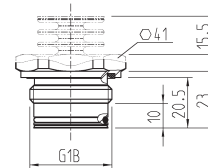
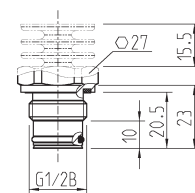
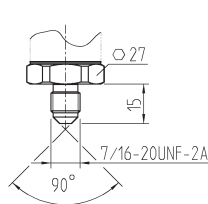
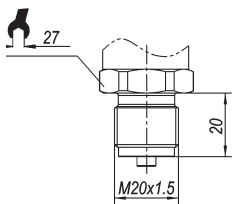

For installation and safety instructions see the operating instructions for this product.  
 Integrated cooling elements only for flush-mounted membrane and medium temperature -20°C ... +150°C.

**Pressure port:** Reduced diameters 0.3 mm or 0.6 mm optionally available for process connection G1/4 acc. to DIN3852 E.

**Electrical connections**

DIN 175301-803 A  
L-Connector for conductor cross section up to max. 1.5 mm<sup>2</sup>, conductor outer diameter 6... 8 mm

2-wire

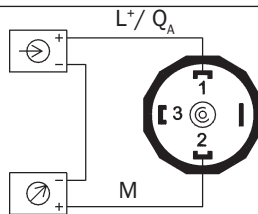

3-wire

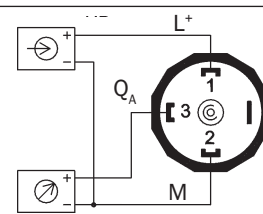

M 12x1, 4-pin  
Circular connector

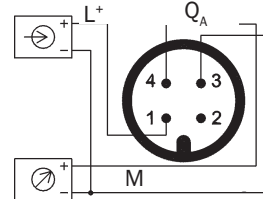
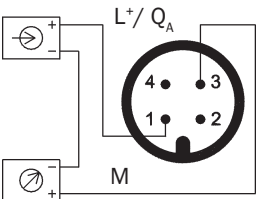

Flying leads for conductor cross section 0.5 mm<sup>2</sup>, AWG 20 with end splices, conductor outer diameter 6.8 mm

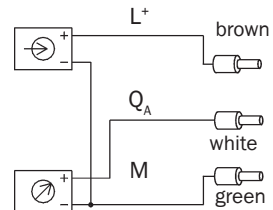
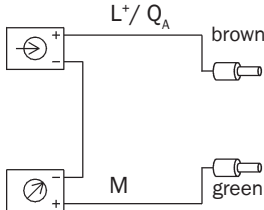

Legend:

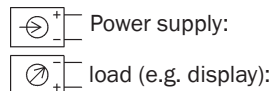

**Accessories**

Weld-in flanges for version with flush-mounted membrane

Part-No.	Model name	Description
5322450	BEF-FL-316G10-B0PH	Flange G 1 B
5322449	BEF-FL-316G12-B0PH	Flange G 1/2 B

For process connector  
order code F1

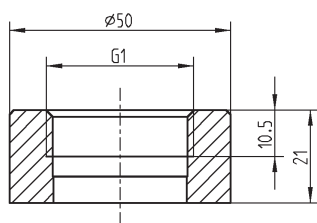

For process connector  
order code F2

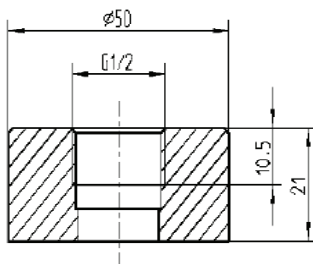

Accessories

PVC circular plug-in connector, M12, 4-pin



DOL	-	12	04	-	G	02M	6009382	2 m
DOL	-	12	04	-	G	05M	6009866	5 m
DOL	-	12	04	-	G	10M	6010543	10 m
DOL	-	12	04	-	G	15M	6010753	15 m
DOL	-	12	04	-	G	20M	6034401	20 m

DOL	-	12	04	-	W	02M	6009383	2 m
DOL	-	12	04	-	W	05M	6009867	5 m
DOL	-	12	04	-	W	10M	6010541	10 m
DOL	-	12	04	-	W	15M	6036474	15 m
DOL	-	12	04	-	W	20M	6033559	20 m

DOL	-	12	04	-	G	01M	S02	6033686	1 m, coating colour gray
DOL	-	12	04	-	G	04M	S02	6033687	4 m, coating colour gray
DOL	-	12	04	-	G	05M	S02	6033688	5 m, coating colour gray
DOL	-	12	04	-	G	07M	S02	6033690	7 m, coating colour gray

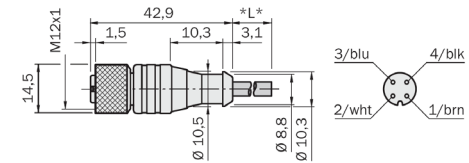
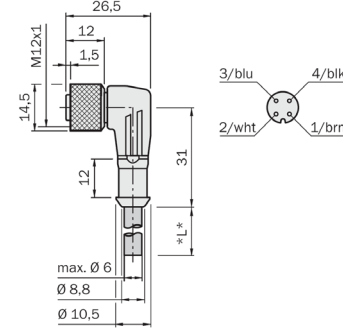
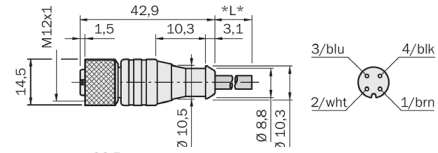

PUR circular plug-in connector M12, 4-pin



DOL	-	12	04	-	G	02M	C	6025900	2 m
DOL	-	12	04	-	G	05M	C	6025901	5 m
DOL	-	12	04	-	G	10M	C	6025902	10 m
DOL	-	12	04	-	G	15M	C	6034749	15 m
DOL	-	12	04	-	G	20M	C	6034750	20 m
DOL	-	12	04	-	G	25M	C	6034751	25 m

DOL	-	12	04	-	W	02M	C	6025903	2 m
DOL	-	12	04	-	W	05M	C	6025904	5 m
DOL	-	12	04	-	W	10M	C	6025905	10 m
DOL	-	12	04	-	W	15M	C	6034752	15 m
DOL	-	12	04	-	W	20M	C	6034753	20 m
DOL	-	12	04	-	W	25M	C	6034754	25 m

DOL	-	12	04	-	G	05M	D	6026250	5 m, welding spark-proof
-----	---	----	----	---	---	-----	---	---------	--------------------------

DOL	-	12	04	-	W	05M	D	6020399	5 m, welding spark-proof
-----	---	----	----	---	---	-----	---	---------	--------------------------

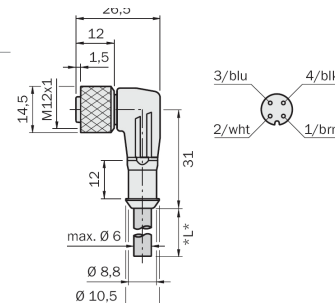
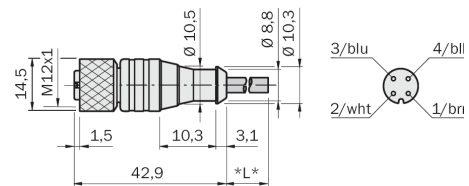
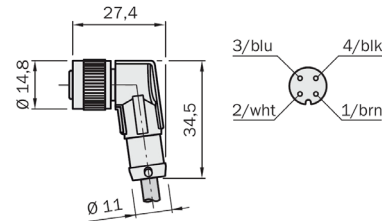
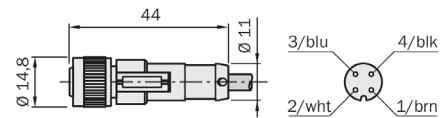





## Type Code

Measurement ranges	bar / Gauge Pressure	bar / Absolute Pressure	bar / Compound Pressure
X10	0...0.1 bar	X25	0...0.25 bar abs
X16	0...0.16 bar	X40	0...0.4 bar abs
X25	0...0.25 bar	X60	0...0.6 bar abs
X40	0...0.4 bar	1X0	0...1 bar abs
X60	0...0.6 bar	1X6	0...1.6 bar abs
1X0	0...1 bar	2X5	0...2.5 bar abs
1X6	0...1.6 bar	4X0	0...4 bar abs
2X5	0...2.5 bar	6X0	0...6 bar abs
4X0	0...4 bar	010	0...10 bar abs
6X0	0...6 bar	016	0...16 bar abs
010	0...10 bar	025	0...25 bar abs <sup>1)</sup>
016	0...16 bar		
025	0...25 bar		
040	0...40 bar		
060	0...60 bar		
100	0...100 bar		
160	0...160 bar		
250	0...250 bar		
400	0...400 bar		
600	0...600 bar		

Measurement ranges	MPa / Gauge Pressure	MPa / Absolute Pressure	MPa / Compound Pressure
10M	0...0.01 MPa	25M	0...0.025 MPa abs
16M	0...0.016 MPa	40M	0...0.04 MPa abs
25M	0...0.025 MPa	60M	0...0.06 MPa abs
40M	0...0.04 MPa	X10	0...0.1 MPa abs
60M	0...0.06 MPa	X16	0...0.16 MPa abs
X10	0...0.1 MPa	X25	0...0.25 MPa abs
X16	0...0.16 MPa	X40	0...0.4 MPa abs
X25	0...0.25 MPa	X60	0...0.6 MPa abs
X40	0...0.4 MPa	1X0	0...1.0 MPa abs
X60	0...0.6 MPa	1X6	0...1.6 MPa abs
1X0	0...1 MPa	2X5	0...2.5 MPa abs <sup>1)</sup>
1X6	0...1.6 MPa		
2X5	0...2.5 MPa		
4X0	0...4 MPa		
6X0	0...6 MPa		
010	0...10 MPa		
016	0...16 MPa		
025	0...25 MPa		
040	0...40 MPa		
060	0...60 MPa		

<sup>1)</sup> Not available with flush-mounted membrane

## Type Code

Measurement ranges	psi / Gauge Pressure	psi / Absolute Pressure	psi / Compound Pressure
5X0	0...5 psi	015	0...15 psi abs
010	0...10 psi	025	0...25 psi abs
015	0...15 psi	050	0...50 psi abs
025	0...25 psi	100	0...100 psi abs
030	0...30 psi	250	0...250 psi abs
050	0...50 psi		
100	0...100 psi		
160	0...160 psi		
200	0...200 psi		
300	0...300 psi		
500	0...500 psi		
1K0	0...1000 psi		
1K5	0...1500 psi		
2K0	0...2000 psi		
3K0	0...3000 psi		
5K0	0...5000 psi		
8K0	0...8000 psi		

Measurement ranges	kg/cm <sup>2</sup> / Gauge Pressure	kg/cm <sup>2</sup> / Absolute Pressure	kg/cm <sup>2</sup> / Compound Pressure
X10	0...0.1 kg/cm <sup>2</sup>	X25	0...0.25 kg/cm <sup>2</sup> abs
X16	0...0.16 kg/cm <sup>2</sup>	X40	0...0.4 kg/cm <sup>2</sup> abs
X25	0...0.25 kg/cm <sup>2</sup>	X60	0...0.6 kg/cm <sup>2</sup> abs
X40	0...0.4 kg/cm <sup>2</sup>	1X0	0...1 kg/cm <sup>2</sup> abs
X60	0...0.6 kg/cm <sup>2</sup>	1X6	0...1.6 kg/cm <sup>2</sup> abs
1X0	0...1 kg/cm <sup>2</sup>	2X5	0...2.5 kg/cm <sup>2</sup> abs
1X6	0...1.6 kg/cm <sup>2</sup>	4X0	0...4 kg/cm <sup>2</sup> abs
2X5	0...2.5 kg/cm <sup>2</sup>	6X0	0...6 kg/cm <sup>2</sup> abs
4X0	0...4 kg/cm <sup>2</sup>	010	0...10 kg/cm <sup>2</sup> abs
6X0	0...6 kg/cm <sup>2</sup>	016	0...16 kg/cm <sup>2</sup> abs
010	0...10 kg/cm <sup>2</sup>	025	0...25 kg/cm <sup>2</sup> abs <sup>1)</sup>
016	0...16 kg/cm <sup>2</sup>		
025	0...25 kg/cm <sup>2</sup>		
040	0...40 kg/cm <sup>2</sup>		
060	0...60 kg/cm <sup>2</sup>		
100	0...100 kg/cm <sup>2</sup>		
160	0...160 kg/cm <sup>2</sup>		
250	0...250 kg/cm <sup>2</sup>		
400	0...400 kg/cm <sup>2</sup>		
600	0...600 kg/cm <sup>2</sup>		

Measurement ranges	mbar / Absolute Pressure	mbar / Compound Pressure	
400	800...1200 mbar abs	600	-600...0 mbar
		400	-400...0 mbar
		250	-250...0 mbar
		160	-160...0 mbar
		100	-100...0 mbar

<sup>1)</sup> Not available with flush-mounted membrane

**Australia**

Phone +61 3 9497 4100  
1800 33 48 02 - tollfree  
E-Mail sales@sick.com.au

**Belgium/Luxembourg**

Phone +32 (0)2 466 55 66  
E-Mail info@sick.be

**Brasil**

Phone +55 11 3215-4900  
E-Mail sac@sick.com.br

**Ceská Republika**

Phone +420 2 57 91 18 50  
E-Mail sick@sick.cz

**China**

Phone +852-2763 6966  
E-Mail ghk@sick.com.hk

**Danmark**

Phone +45 45 82 64 00  
E-Mail sick@sick.dk

**Deutschland**

Phone +49 211 5301-301  
E-Mail info@sick.de

**España**

Phone +34 93 480 31 00  
E-Mail info@sick.es

**France**

Phone +33 1 64 62 35 00  
E-Mail info@sick.fr

**Great Britain**

Phone +44 (0)1727 831121  
E-Mail info@sick.co.uk

**India**

Phone +91-22-4033 8333  
E-Mail info@sick-india.com

**Israel**

Phone +972-4-999-0590  
E-Mail info@sick-sensors.com

**Italia**

Phone +39 02 27 43 41  
E-Mail info@sick.it

**Japan**

Phone +81 (0)3 3358 1341  
E-Mail support@sick.jp

**Nederlands**

Phone +31 (0)30 229 25 44  
E-Mail info@sick.nl

**Norge**

Phone +47 67 81 50 00  
E-Mail austefjord@sick.no

**Österreich**

Phone +43 (0)22 36 62 28 8-0  
E-Mail office@sick.at

**Polska**

Phone +48 22 837 40 50  
E-Mail info@sick.pl

**Republic of Korea**

Phone +82-2 786 6321/4  
E-Mail kang@sickkorea.net

**Republika Slovenija**

Phone +386 (0)1-47 69 990  
E-Mail office@sick.si

**România**

Phone +40 356 171 120  
E-Mail office@sick.ro

**Russia**

Phone +7 495 775 05 34  
E-Mail info@sick-automation.ru

**Schweiz**

Phone +41 41 619 29 39  
E-Mail contact@sick.ch

**Singapore**

Phone +65 6744 3732  
E-Mail admin@sicksgp.com.sg

**Suomi**

Phone +358-9-25 15 800  
E-Mail sick@sick.fi

**Sverige**

Phone +46 10 110 10 00  
E-Mail info@sick.se

**Taiwan**

Phone +886 2 2375-6288  
E-Mail sickgrc@ms6.hinet.net

**Türkiye**

Phone +90 216 587 74 00  
E-Mail info@sick.com.tr

**USA/Canada/México**

Phone +1(952) 941-6780  
1 800-325-7425 - tollfree  
E-Mail info@sickusa.com

More representatives and agencies  
in all major industrial nations at  
[www.sick.com](http://www.sick.com)